

BORA



LEVER



JEFFERSON HIGH SCHOOL MODERNIZATION

Comprehensive Planning Committee

Meeting One: Process, Overview & Design Justice Introduction

June 1, 2022

AGENDA

Welcome & Introductions	PPS
Overview of CPC process	PPS
Background / 2019 Study	Bora
Break and review of Open House boards	
Discussion / Questions	All
Design Justice Presentation	Colloqate
Preparation for next CPC meeting	PPS
Public Comment Period	Public

PROJECT TEAM

PORTLAND PUBLIC SCHOOLS

Steve Effros - Senior Project Manager

Kiesha Locklear - Project Manager

Ayana Horn - Project Manager

BORA

Becca Cavell - Project Manager, Point of Contact

Jeanie Lai - Design Principal, Interior

Chris Linn - Principal in Charge

Miguel Hidalgo - Project Architect

Corey Squire - Sustainability Lead

Kayce Joyce - Project Team, Interior

Elizabeth Lee - Project Administrator

LEVER

Chandra Robinson - Design Principal, Exterior

Sean Bolden - Project Architect, Exterior

Dannon Canterbury - Project Manager, Exterior

COLLOQATE

Bryan C. Lee Jr. - Engagement Lead

Bryan Bradshaw - Engagement Team

Natalia Revelo LaRotta - Engagement Team

HOOD DESIGN STUDIO

Walter Hood - Urban Design Principal

PLACE

Mauricio Villareal - Design Principal, Landscape

YOUR STREET YOUR VOICE

Jackie Santa Lucia - Student Engagement

PORTLAND PUBLIC SCHOOLS BOND PROGRAM OVERVIEW

PPS BOND TIMELINE

2012 BOND

Roosevelt HS Modernization
Franklin HS Modernization
Grant HS Modernization
Faubion PK-8 Rebuild
Improvement Projects

2017 BOND

McDaniel HS Modernization
Kellogg MS Rebuild
Lincoln HS Rebuild
Benson HS Modernization
Health & Safety Projects

2020 BOND

Jefferson HS Modernization
Cleveland HS Master Planning
Ida B Wells HS Master Planning
Capacity Projects
Infrastructure Projects
Curriculum
Technology

HERE

JEFFERSON HS MODERNIZATION - WORK TO DATE

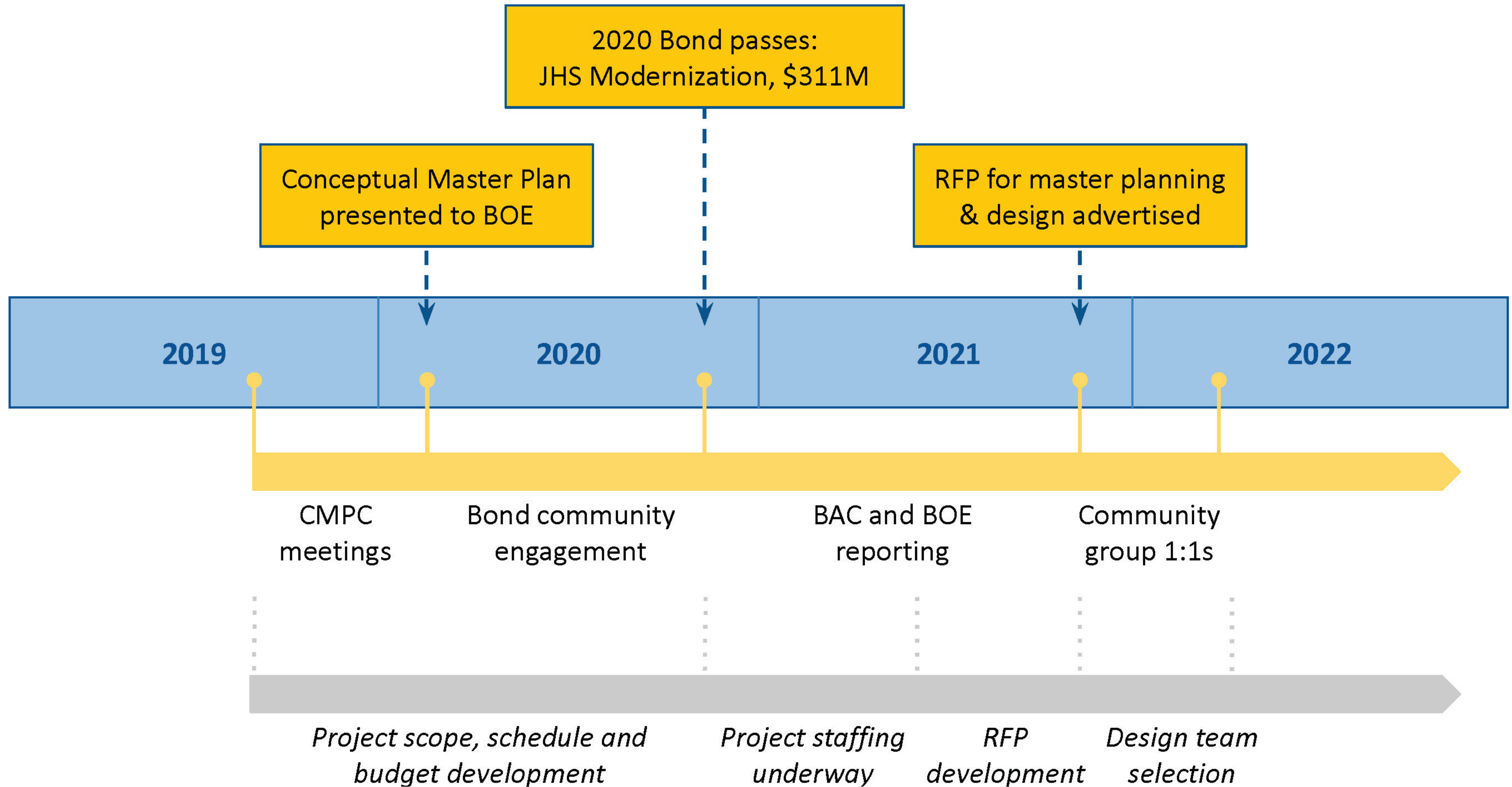

CPC SCHEDULE

PPS | Jefferson High School Comprehensive Planning Phase

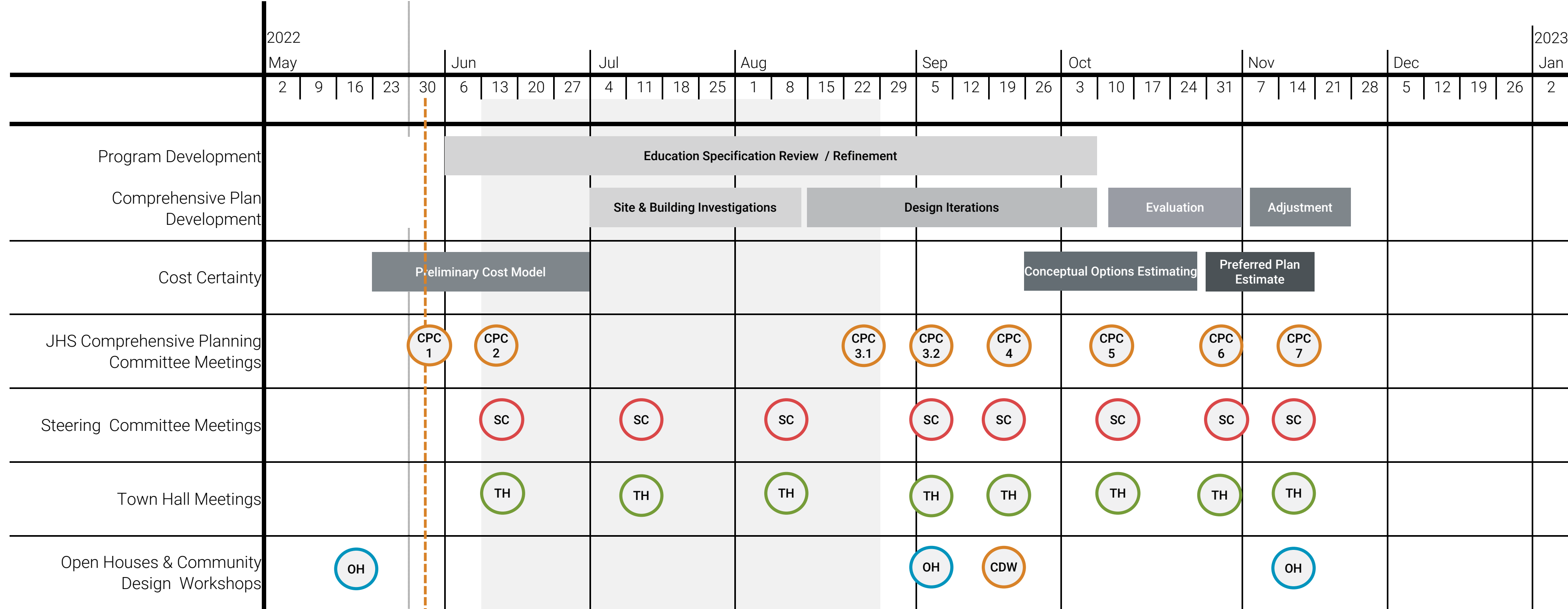

June 1, 2022	Comprehensive Planning Committee Meeting CPC 1	Process, Overview, Design Justice Introduction
June 15, 2022	Comprehensive Planning Committee Meeting CPC 2	Vision, Mission and Goals
August 24, 2022	Comprehensive Planning Committee Meeting CPC 3.1	Site Plan Scenarios Session 1
September 7, 2022	Comprehensive Planning Committee Meeting CPC 3.2	Site Plan Scenarios Session 2
September 21, 2022	Comprehensive Planning Committee Meeting CPC 4	Program & Design Options
October 12, 2022	Comprehensive Planning Committee Meeting CPC 5	Multiple Massing Options
November 2, 2022	Comprehensive Planning Committee Meeting CPC 6	Three Massing Options
November 16, 2022	Comprehensive Planning Committee Meeting CPC 7	Cost Review / Selection

2019 BOND STUDY

FLOOR PLANS PROGRAM ANALYSIS

BASEMENT (A FLOOR)

- EDUCATIONAL SUPPORT
- GENERAL EDUCATION
- SCIENCE EDUCATION
- PHYSICAL EDUCATION
- FINE & PERFORMING ARTS
- CTE
- RESTROOM & MECHANICAL
- WRAP-AROUND & PARTNERSHIPS
- PPS DISTRICT USES

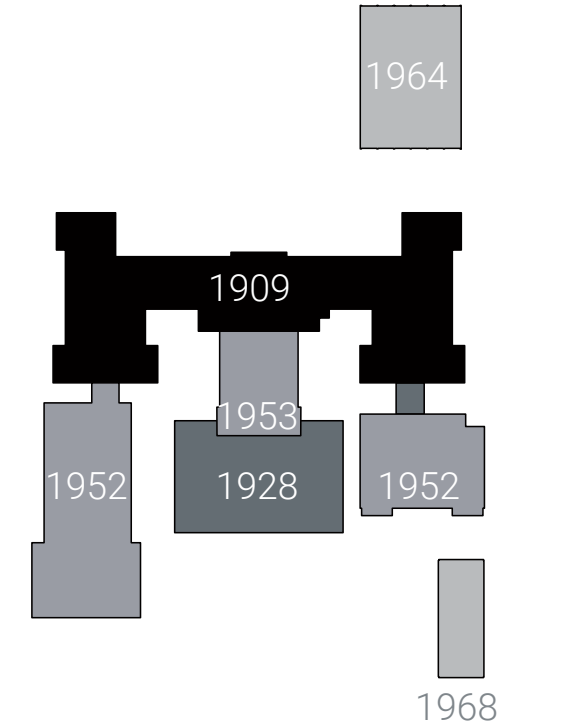

Building Key

FLOOR PLANS PROGRAM ANALYSIS

FIRST FLOOR (B FLOOR)

- EDUCATIONAL SUPPORT
- GENERAL EDUCATION
- SCIENCE EDUCATION
- PHYSICAL EDUCATION
- FINE & PERFORMING ARTS
- CTE
- RESTROOM & MECHANICAL
- WRAP-AROUND & PARTNERSHIPS
- PPS DISTRICT USES

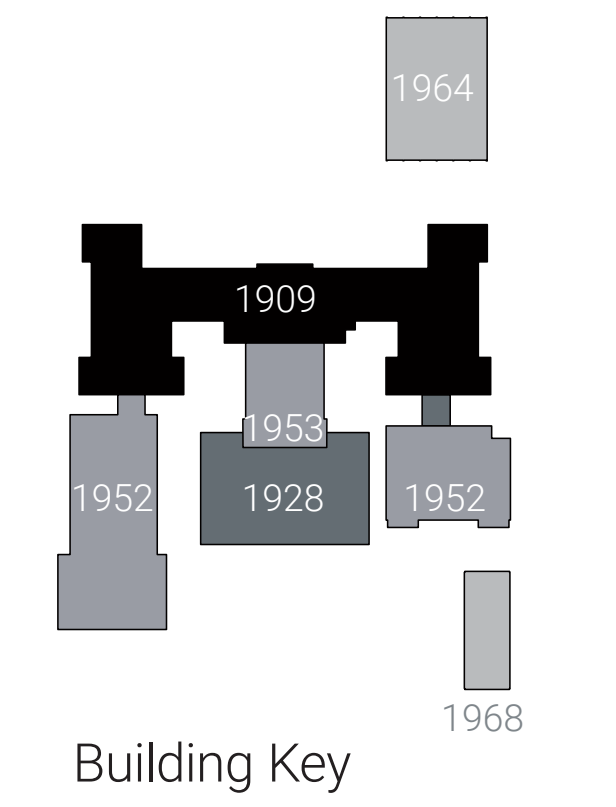

FLOOR PLANS PROGRAM ANALYSIS

SECOND FLOOR (C FLOOR)

- EDUCATIONAL SUPPORT
- GENERAL EDUCATION
- SCIENCE EDUCATION
- PHYSICAL EDUCATION
- FINE & PERFORMING ARTS
- CTE
- RESTROOM & MECHANICAL
- WRAP-AROUND & PARTNERSHIPS
- PPS DISTRICT USES

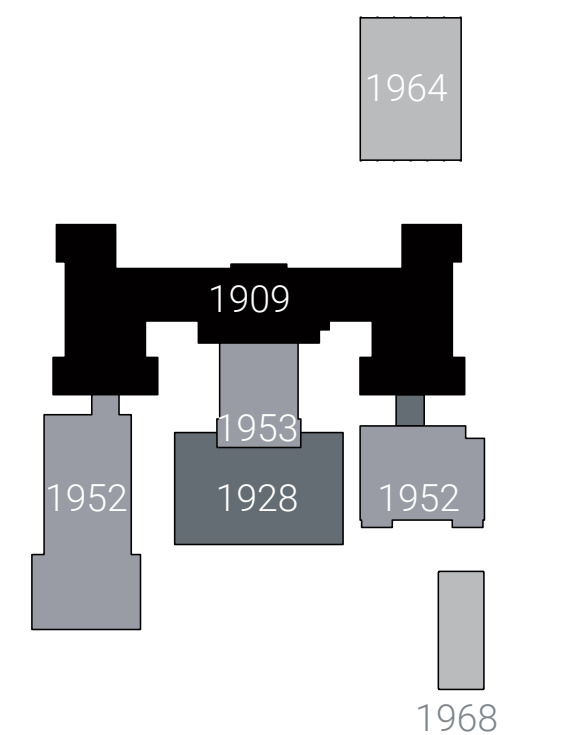
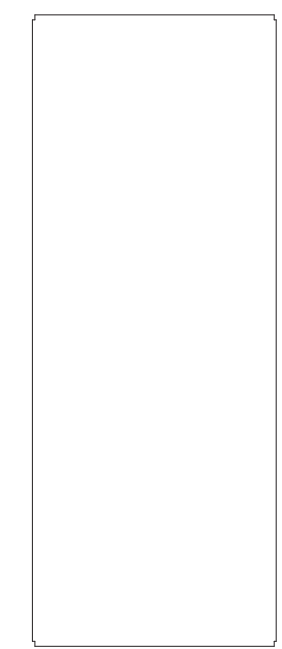

BORA LEVER



FLOOR PLANS PROGRAM ANALYSIS

THIRD FLOOR (D FLOOR)

- EDUCATIONAL SUPPORT
- GENERAL EDUCATION
- SCIENCE EDUCATION
- PHYSICAL EDUCATION
- FINE & PERFORMING ARTS
- CTE
- RESTROOM & MECHANICAL
- WRAP-AROUND & PARTNERSHIPS
- PPS DISTRICT USES

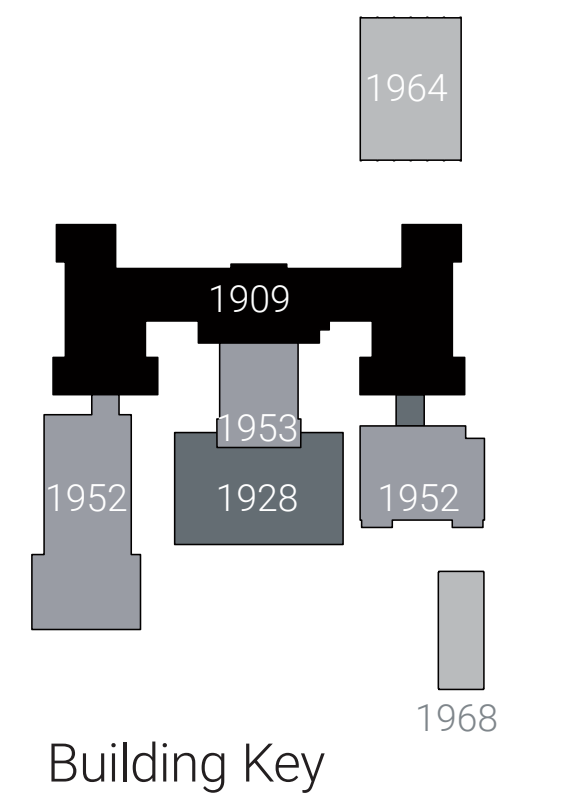

PROGRAM COMPARISON ED SPEC TO NEW JEFFERSON HIGH SCHOOL



ED SPEC



JHS

ED SPEC: 206,690 NSF
JEFFERSON: 228,010 NSF

SITE PLAN CURRENT



AERIAL VIEW FROM SOUTH WEST



AERIAL VIEW FROM SOUTH WEST ADDITIONS

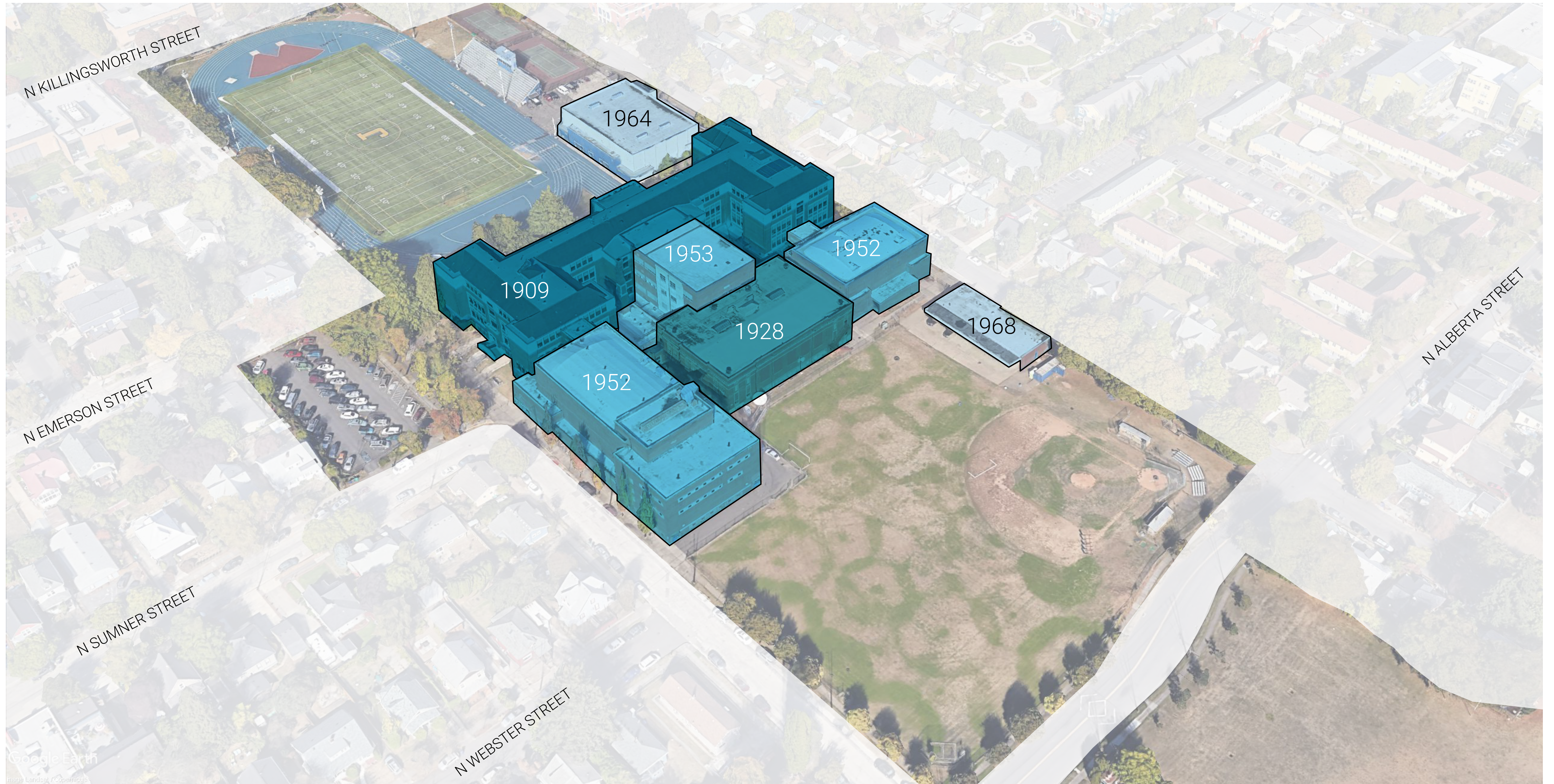

AERIAL VIEW FROM SOUTH WEST UNIVERSAL ACCESS

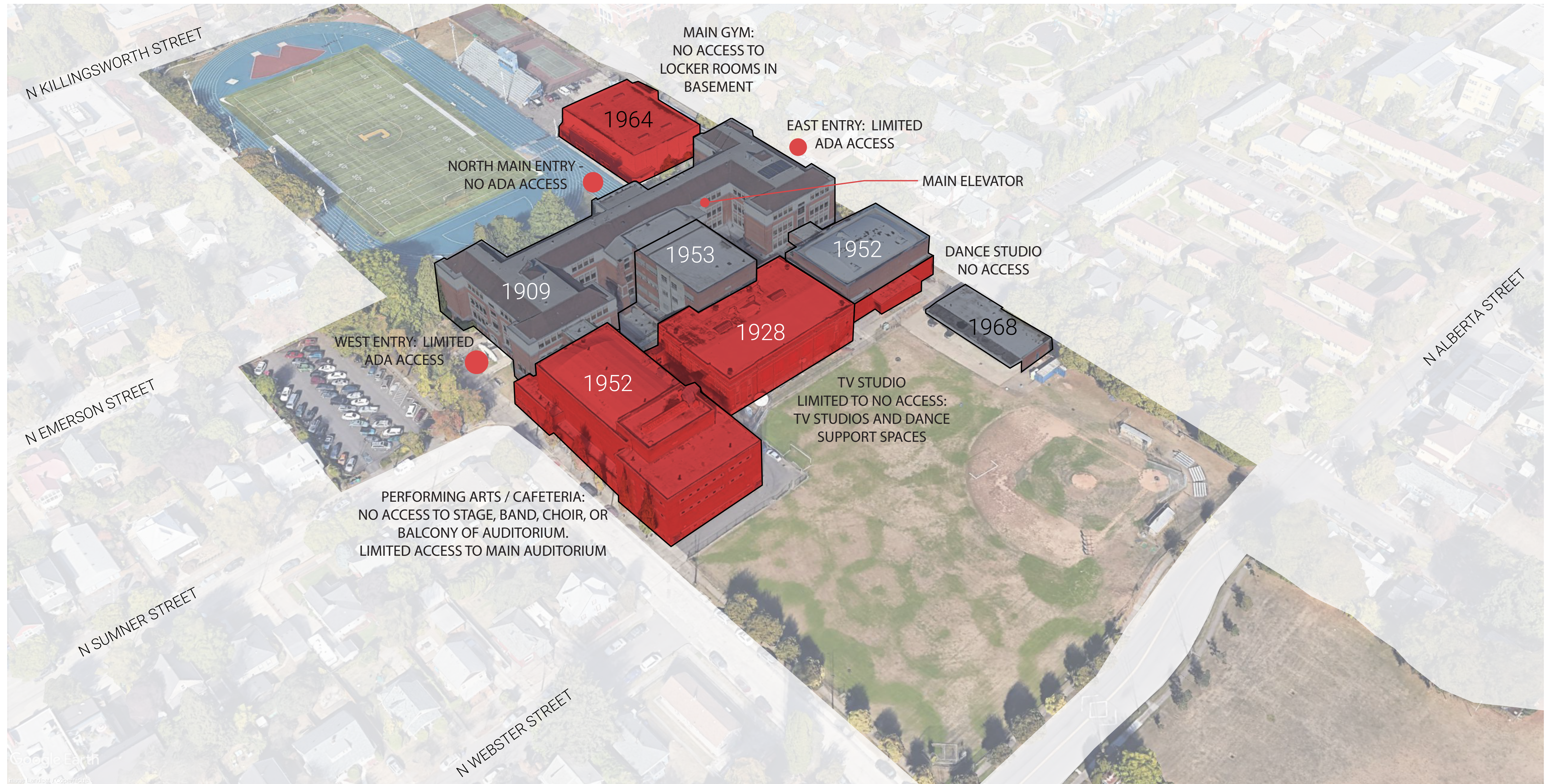

AERIAL VIEW FROM SOUTH WEST STRUCTURAL SEISMIC UPGRADES

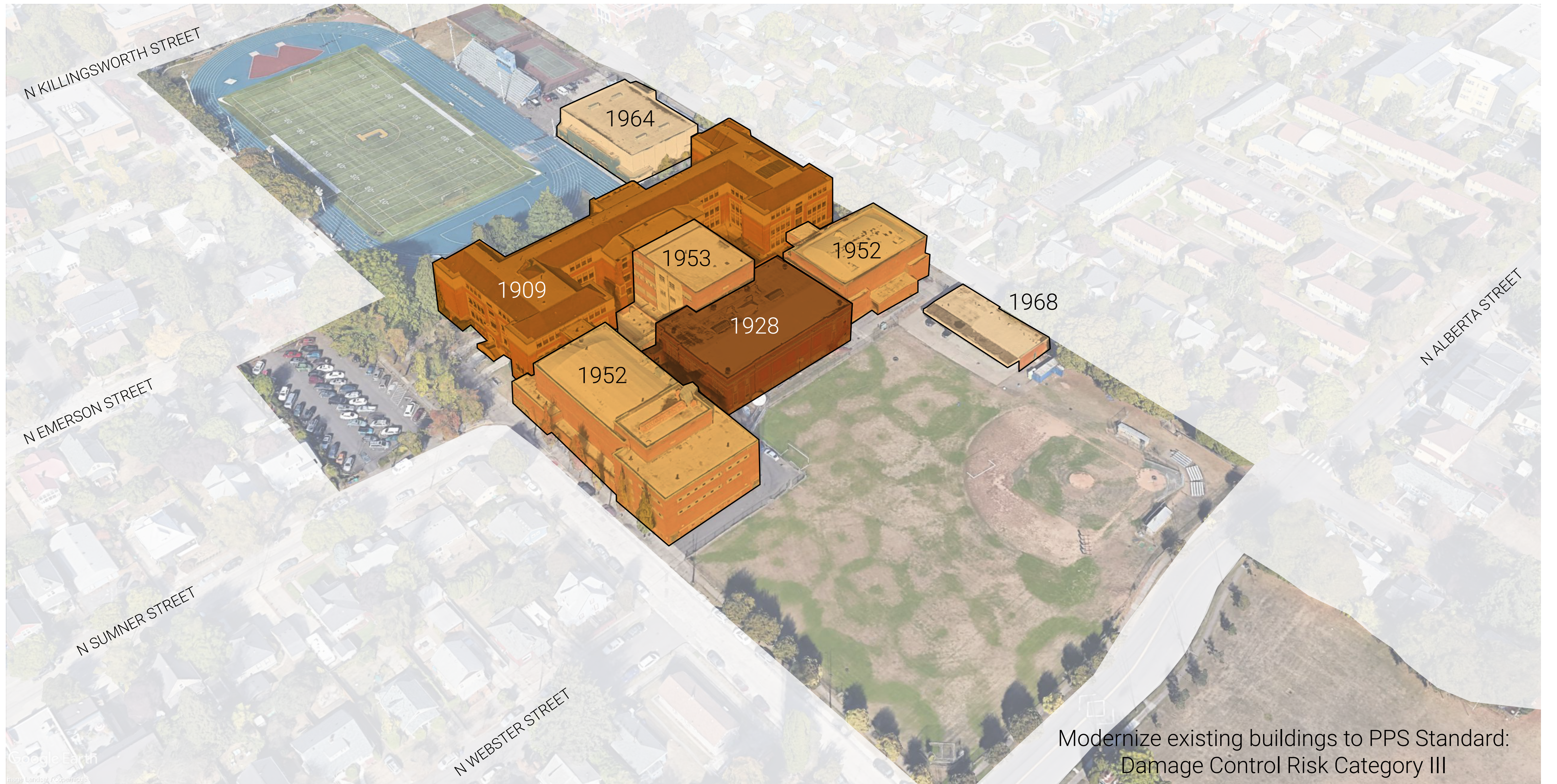

Google Earth
Image Landsat / Copernicus

SITE PLAN SETBACKS

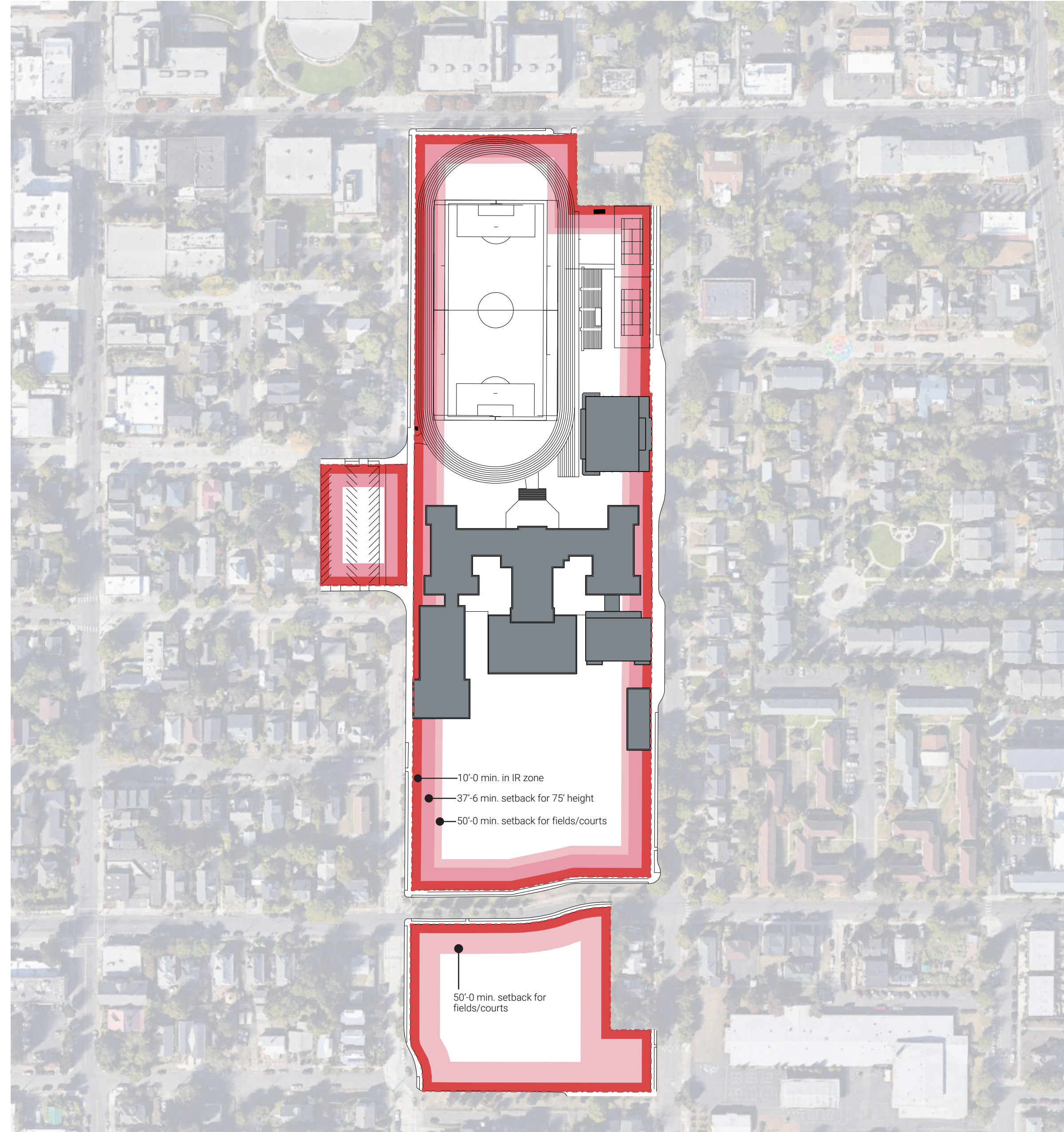

CMPC PROCESS GROUP EXERCISES

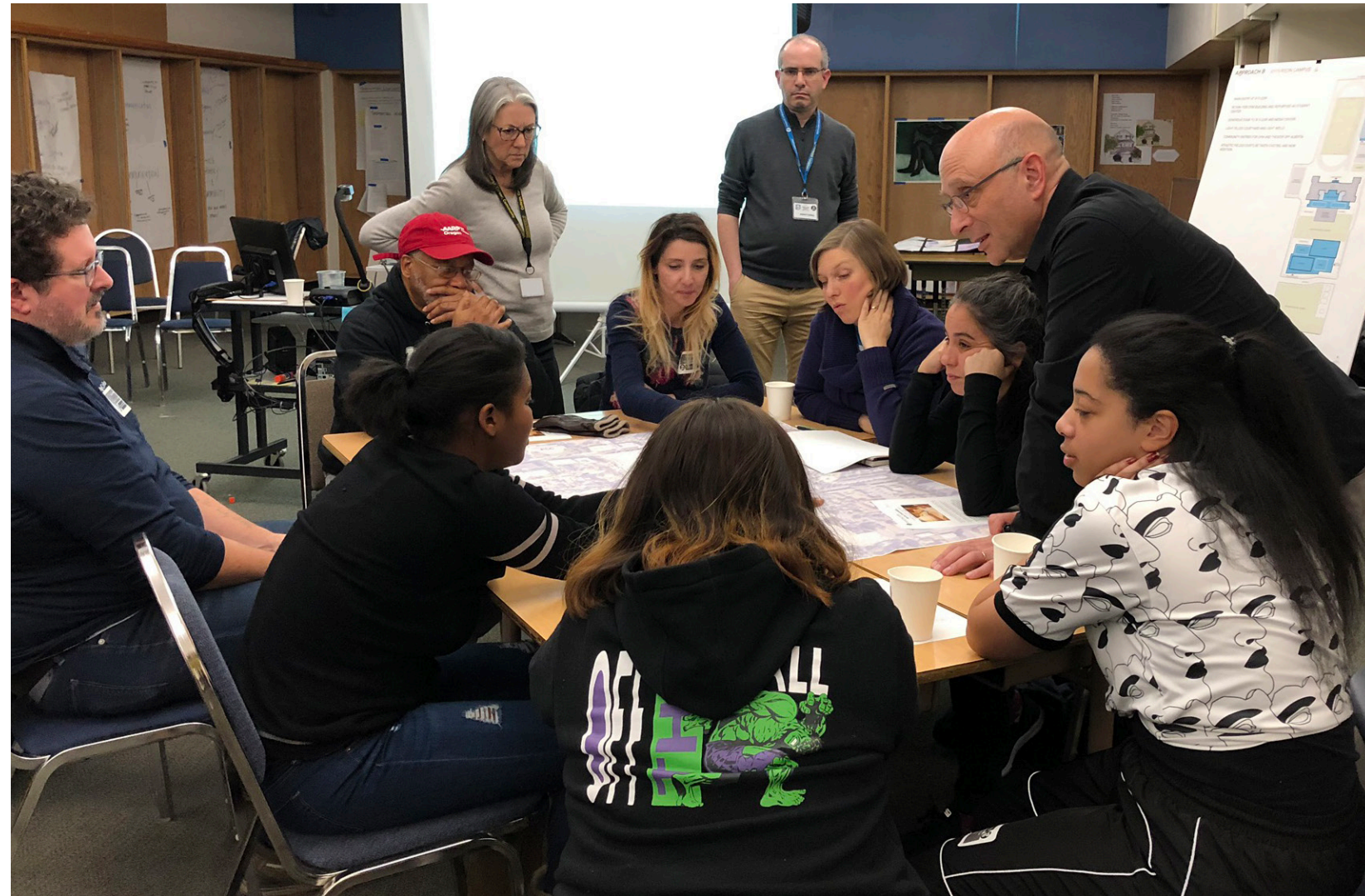

CMPC THEMES

Offer access to the community and be a hub for its community

Honor Jefferson's history as Portland's black high school and celebrate its future diversity

Create a flexible and adaptable design

Provide welcoming, safe, resilient and accessible facilities

Offer a rich variety of educational opportunities and maintain strong partner programs

Outreach and engagement are essential

CMPC 3 GROUP WORK



TEAM 1

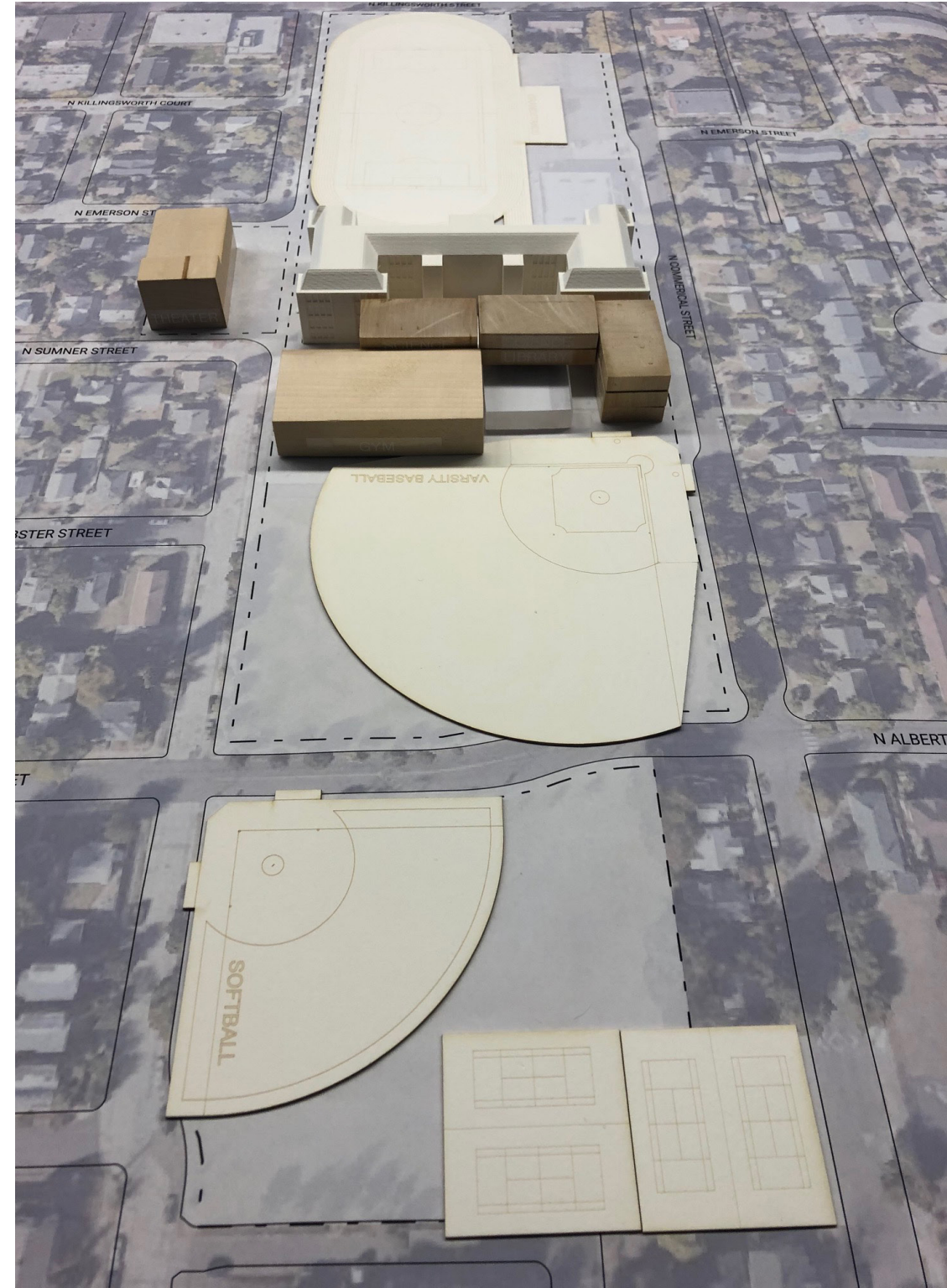

TEAM 2

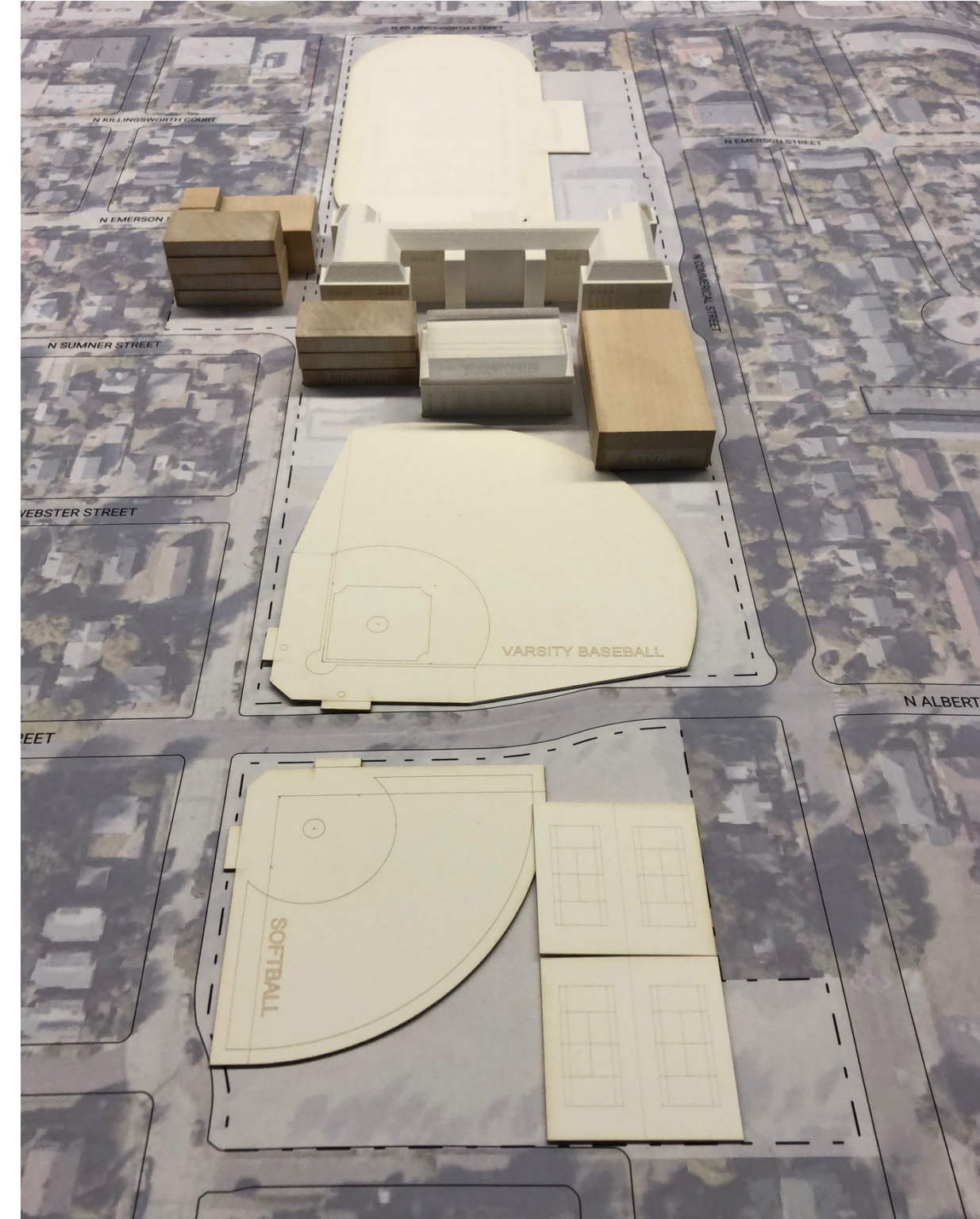

TEAM 3



TEAM 4

CMPC 4 GROUP WORK



APPROACH A



APPROACH B



APPROACH C

CMPC-4

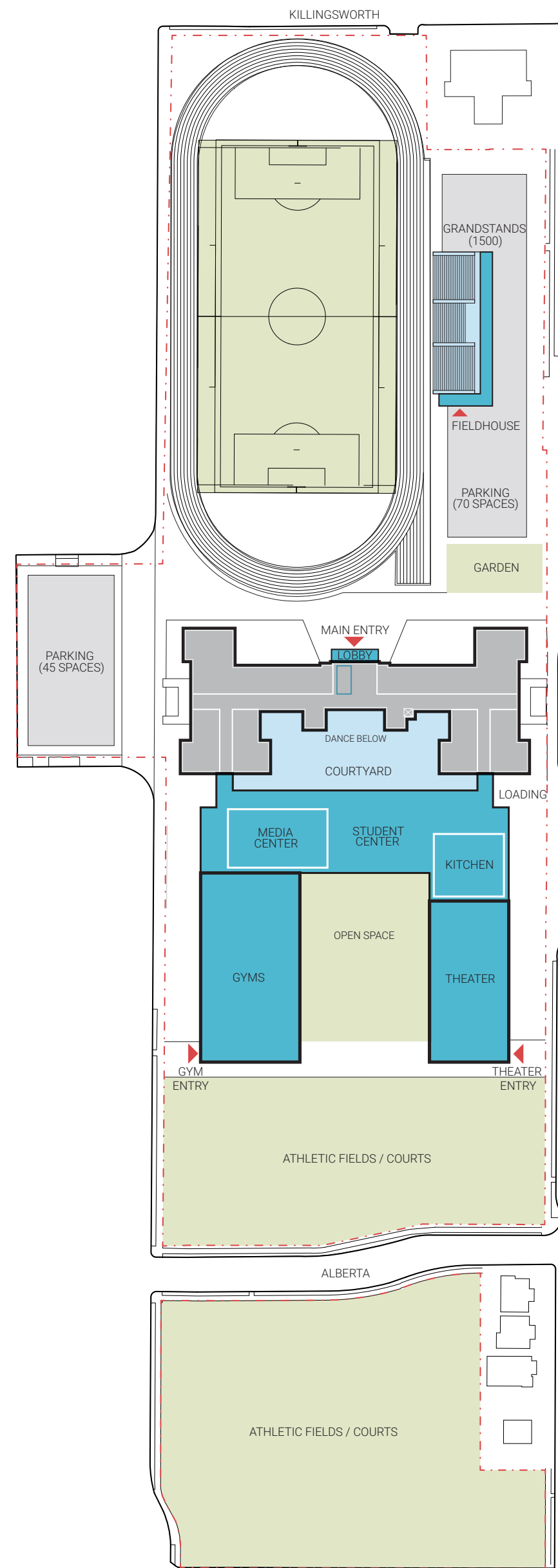

APPROACH A

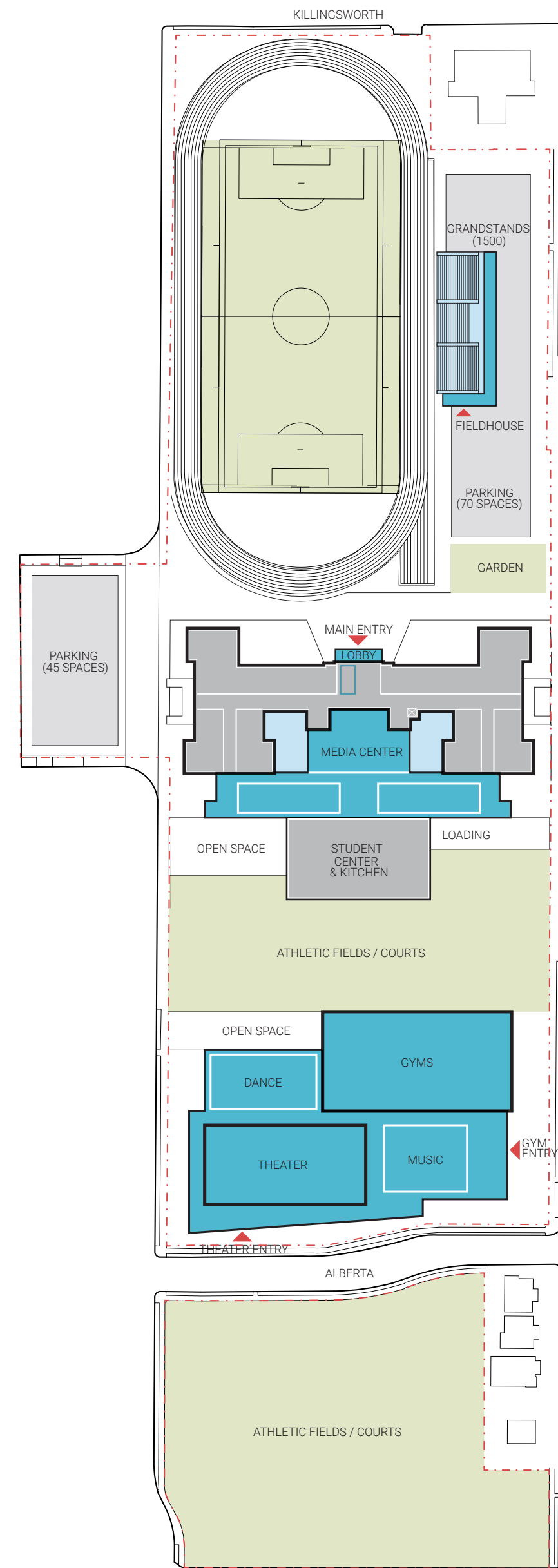

APPROACH B

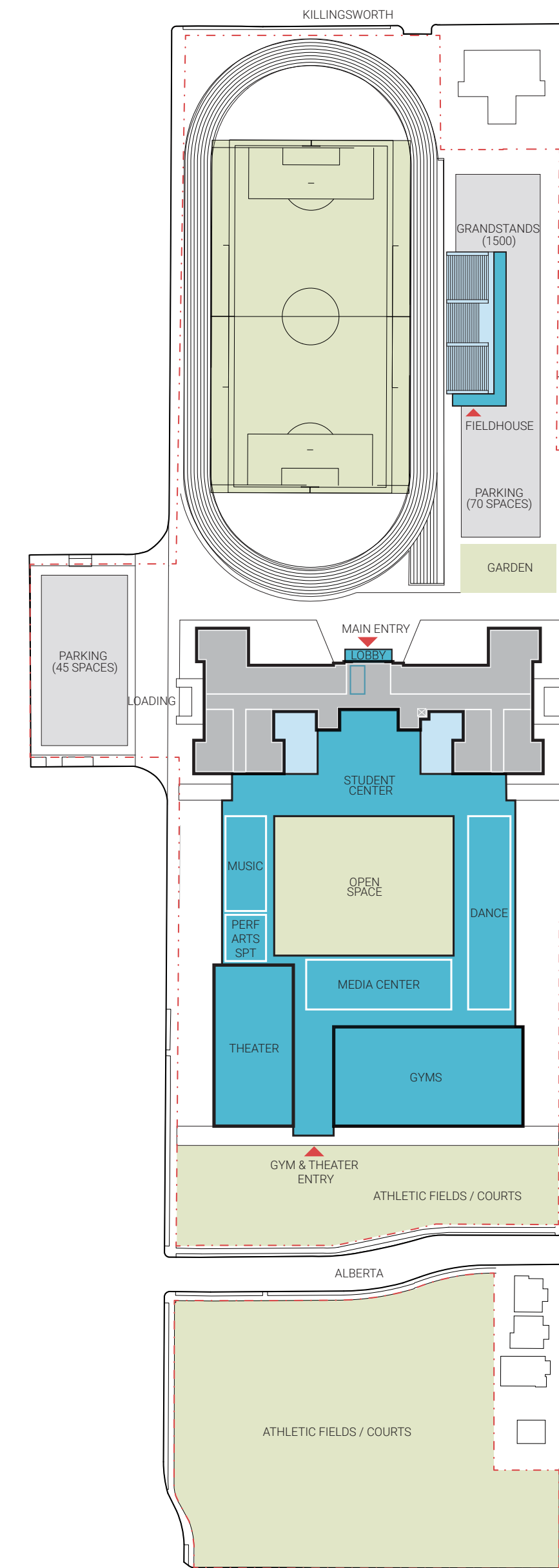

APPROACH C



REPORT - SITE ORGANIZATION PLAN

Upon the conclusion of CMPC Meeting 5, Bora synthesized a single conceptual option that was then forwarded to the cost estimating team for review and pricing. This conceptual option addresses many, but not all, of the ideas expressed by the CMPC. **The selection of this option does not indicate that it is the final recommendation.** Rather, it is the option that is most indicative of the likely construction cost. There will be ample time for community review and revise the design direction once the project is funded and moves forward.

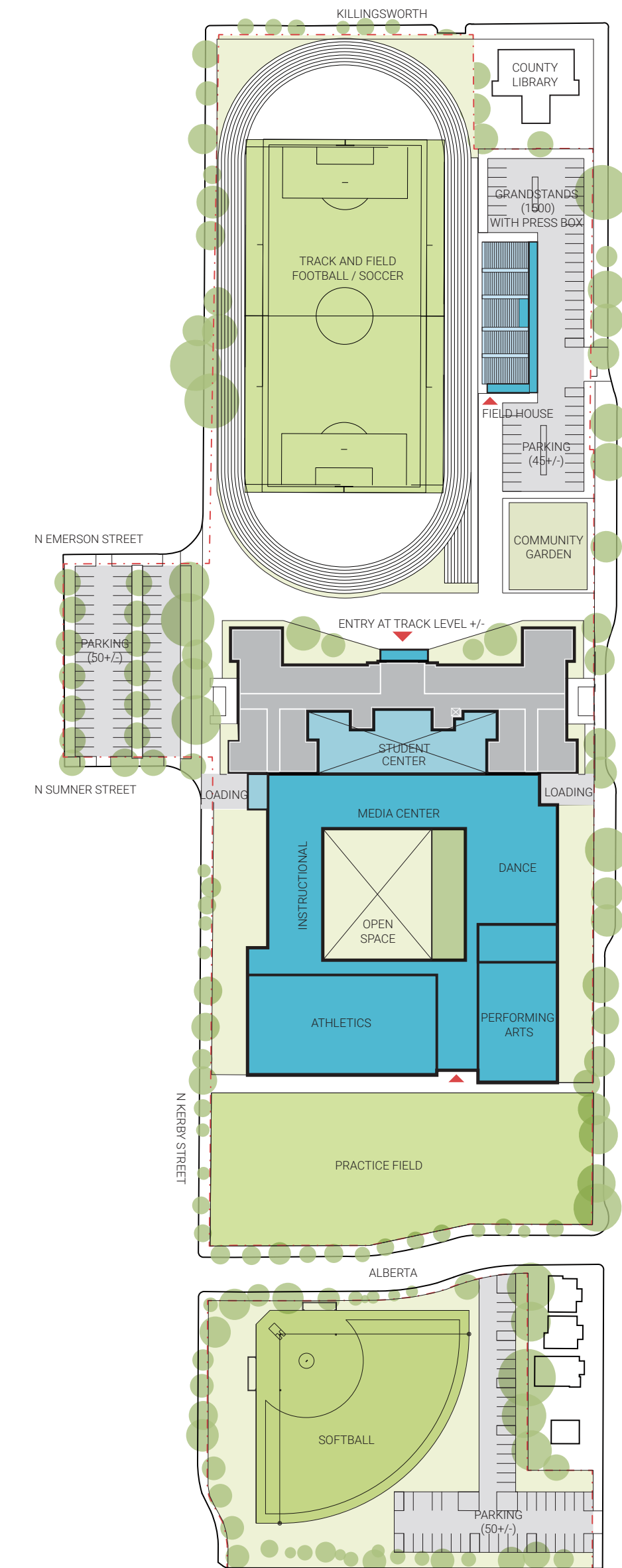

SITE PLAN



REPORT - PLANS

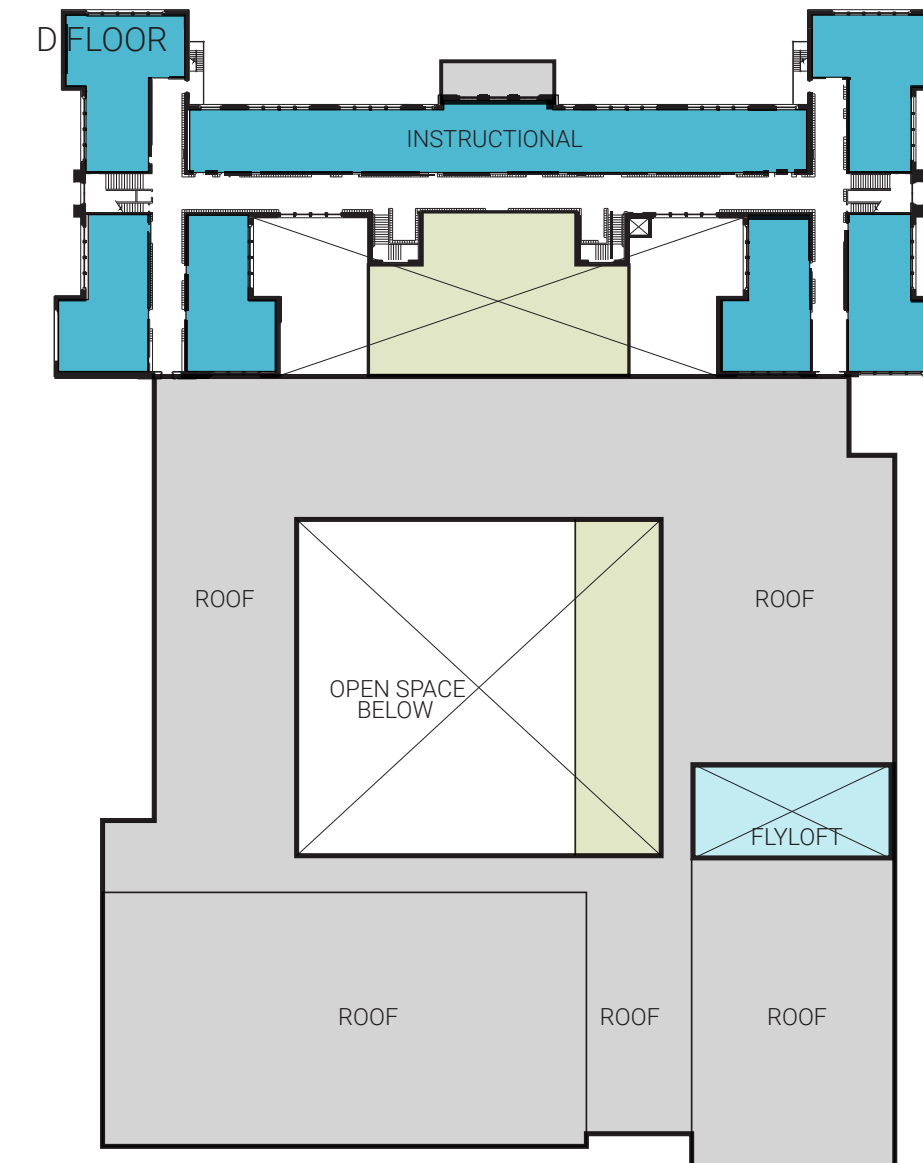
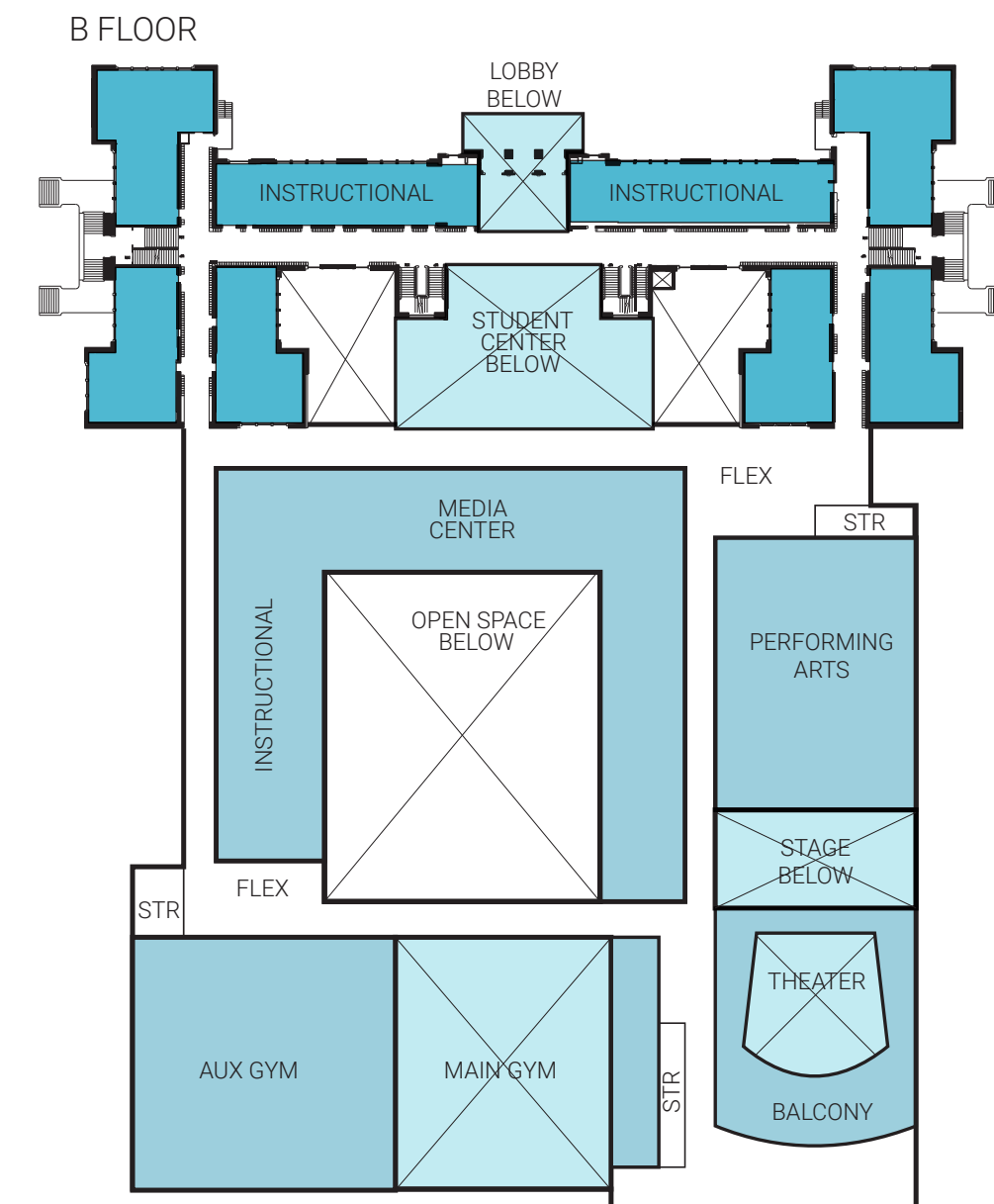
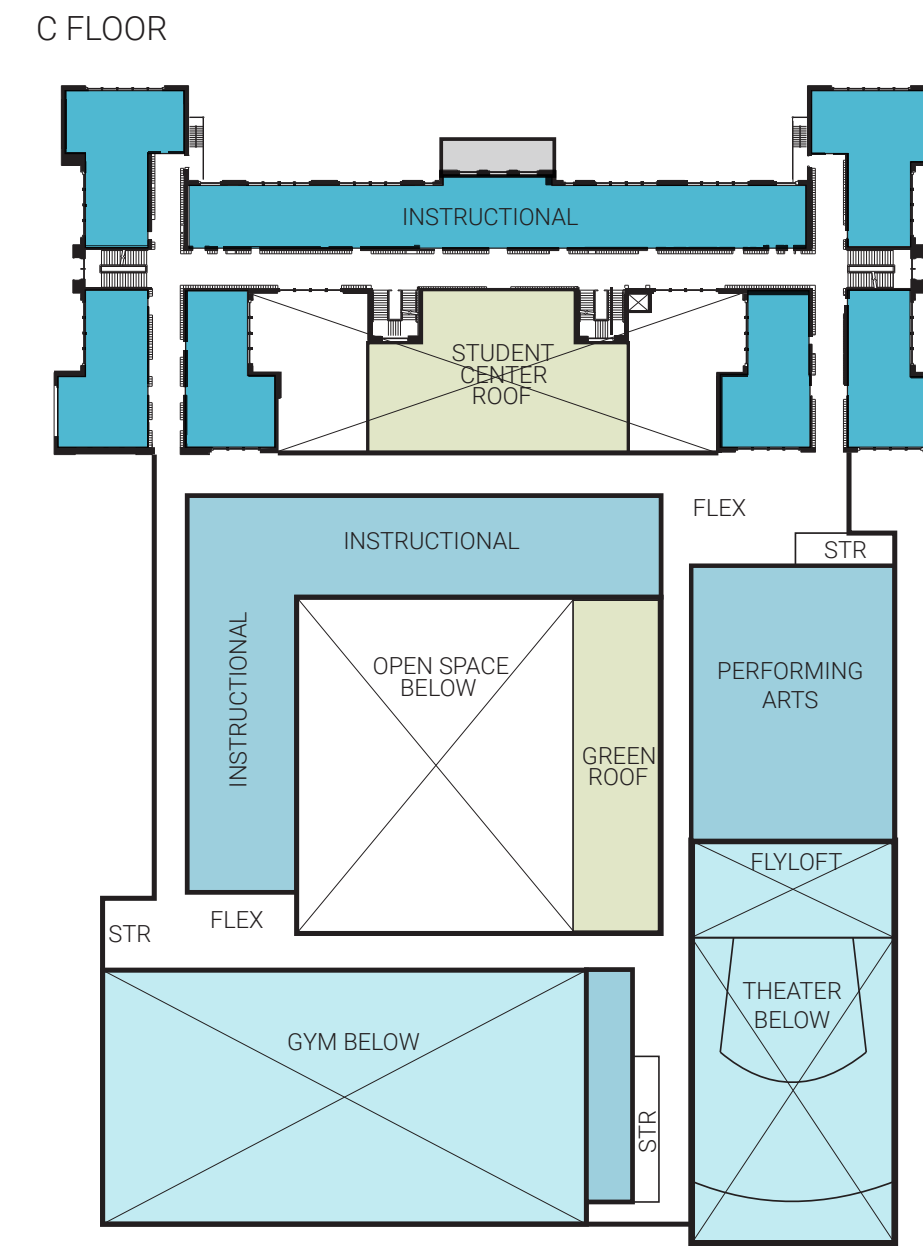
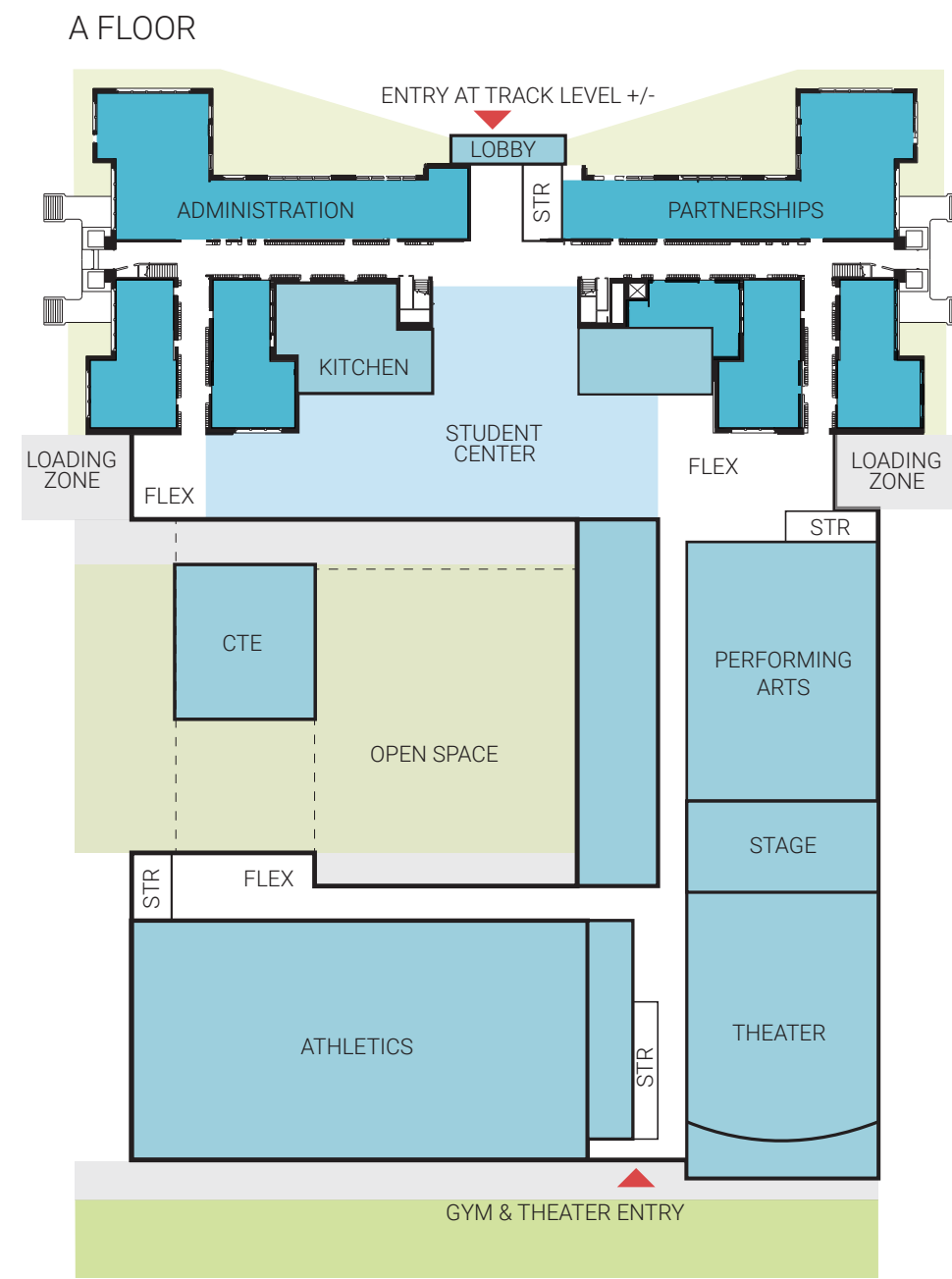

REPORT - SITE PHASING DIAGRAMS

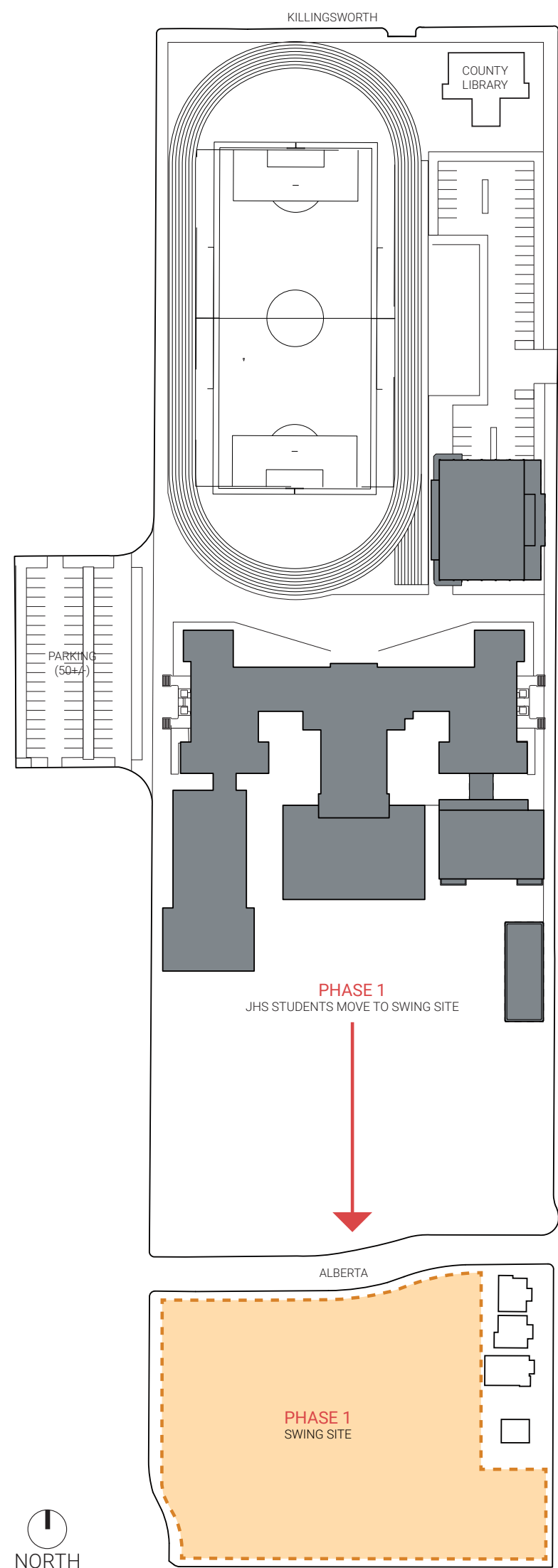

PHASE 1

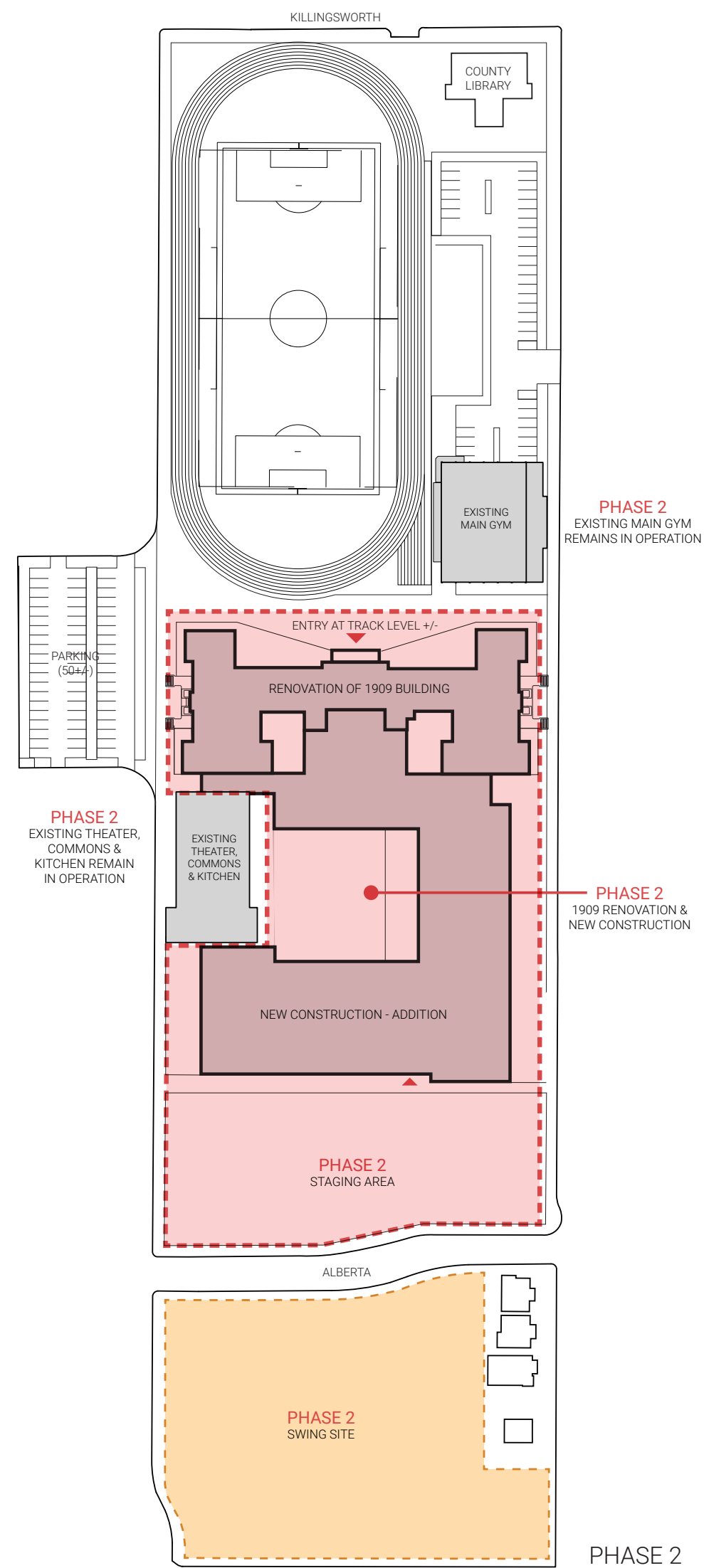

PHASE 2

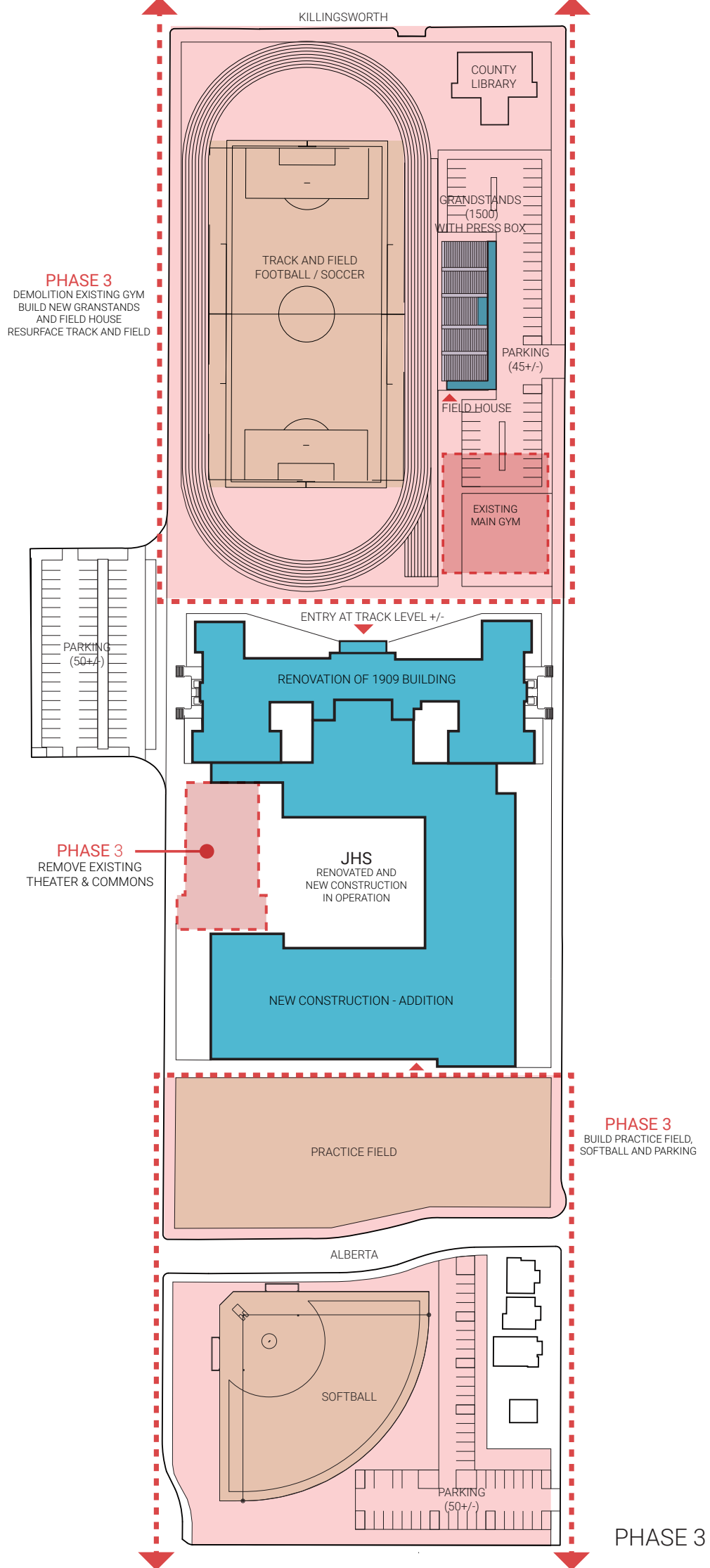

PHASE 3

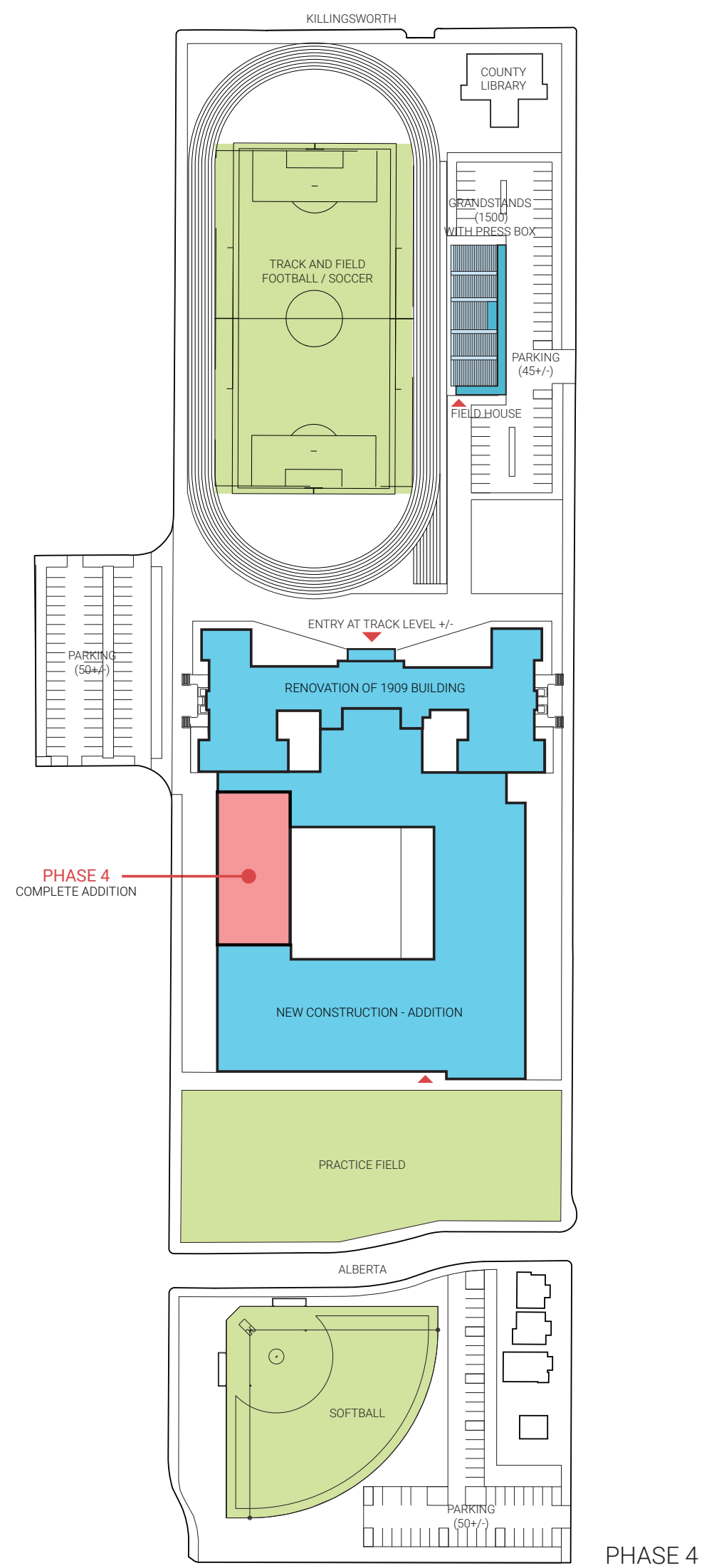

PHASE 4





NGSWORTH STREET

SON STREET

N SUMNER STREET

N WEBSTER STREET

N ALBERT